

iviflo®

Editia 1 2009



CATALOG PRODUSE



PRODUCT CATALOGUE

iviflo®

Cuple din bronz
Brass couplings



Raufoss Water & Gas AS

Brass couplings Raufoss Water & Gas AS este detinuta de grupul industrial olandez Aalberts Industries AV.

Raufoss Water & Gas AS dezvolta si aprovizioneaza cuplajele Isiflo si produsele conexe industriei Europene de distributie de apa si gaz.

Gama de produse Isiflo este compusa din urmatoarele: cuplele din bronz Isiflo, vane Isiflo, axe Isiflo, fittinguri filetate Isiflo, colierele de bransament Isiflo, cuplajele din fonta ductile si cuplajele Isiflex. De asemenea comercializam produse de la Broen, Belgicast si Leya.

Raufoss Water & Gas AS a construit o vasta retea de distributie si de companii fice, agentii si distribuitori independenti si este reprezentata acum in 21 de tarii Europeene.

Gama de fittinguri universal sunt produse la Raufoss si au fost concepute pentru a fi folosite cu tevi din PE, PVC, otel, cupru si plumb. Produsul este rezultatul dezvoltarii si a competentei in materiale si a fost dovedita de peste cei 30 de ani de experienta in conditii extreme. Raufoss este leader in piata Europeana a cuplajelor pentru retele de distributie a apei si gazului si au fost vandute peste 180 milioane de cuple.



Raufoss Water & Gas AS is owned by the dutch industrial group Aalberts Industries NV.

Raufoss Water & Gas develops and supply's ISIFLO Couplings and related products to the European water and gas distribution industry. Our products are ISIFLO Brass couplings, ISIFLO Gate valves, ISIFLO spindles, ISIFLO Threaded pipe fittings, ISIFLO Tapping saddles, ISIFLO Ductile Irons and ISIFLEX. We also market products from Broen, Belgicast and Leya.

Raufoss Water & Gas AS has established a comprehensive distribution network of daughter companies, agents and independent distributors, and is currently represented in 21 European countries.

The ISIFLO universal range of brass couplings is manufactured at Raufoss, and has been developed for use with PE/PVC, steel, copper and lead pipe. The product is a result of Raufoss' development- and material competence, and has been proven by over 30 years of field experience under extreme conditions. Raufoss is the European market leader for this type of water and gas distribution couplings and over 180 million couplings have been supplied.

Cuprins

| Cuprins | Pagina |
|---|--------|
| Raufoss Water & Gas AS | 2-3 |
| Programul cuple din bronz/Brass couplings program | 5-14 |
| Informatii tehnice/Technical information | 15 |
| Programul cuple din bronz/Brass couplings program - dimensiuni cuple/dimensions | 16-25 |
| Ghid de identificare dupa dimensiuni / Productfinder - dimensions | 26/27 |
| Materiale/Material | 28-29 |
| Instructiuni asamblare/Assembly instruction | 30 |
| Exemple de asamblari/Assembly examples | 31-35 |

Raufoss Water & Gas AS

Concept / Concept

Conceptul de afaceri Raufoss Water and Gas doreste sa realizeze valoare prin dezvoltarea si livrarea de produse prietenoase cu mediul ambiental care in acelasi timp sa fie de inalta calitate si sa satisfaca toate cerintele clientilor din domeniul retelelor de distributiei de apa, gaz si scurgere.

The Raufoss Water & Gas business concept is to generate value through the development and supply of environmental friendly products of high quality, which meet all customer requirements related to water, drainage and gas distribution networks.

Calitate / Quality

Raufoss Water & Gas detine certificatul de mediu ISO 14001 .

Compania a obtinut certificatul in managementul calitatii ISO 9001 : 2000.

Raufoss Water & Gas AS holds the environmental certificate according to ISO 14001.

The company has an established quality management system according to ISO 9001:2000.



Competenta / Competence

Departamentele noastre de Vanzari, Marketing si cel de Dezvoltare, va vor sustine in orice problema legata de produse si de conditiile de vanzare.

Our sales-& marketing and R&D department will give you support with all questions regarding products, prices and sales conditions.

Documentatie / Documentation

Mai multe informatii si documentatie privind produsele noastre sunt disponibile in brosurile noastre si pe pagina noastra de internet la adresa www.isiflo.com.

Information about our company and products are available in our product brochures and on www.isiflo.com.



Cercetare si dezvoltare / R&D

Un inalt nivel de auto-dezvoltare a noilor produse sia solutiilor sunt realizate la Raufos si noi oferim clientilor beneficiul eforturilor acestui departament de dezvoltare, centrului de competenta al materialelor si a laboratoarelor performante de testat material.

A high level of in-house development of new products and solutions is performed at Raufoss, and we offer our customers the benefits provided by our development department, material competence centre and extensive test facilities.



Productie / Own production

Raufoss Water & Gas AS detine marca inregistrata "Isiflo" - care unul dintre cele mai puternice branduri din interiorul industriei Europeene de apa si gaz. Gama de fittinguri universal din bronz Isiflo si fittingurile-K sunt produse intr-o fabrica construita recent la Raufoss.

Raufoss Water & Gas AS holds the trademark "ISIFLO" - which is one of the strongest brands inside the European water- and gas industry. ISIFLO universal range of brass couplings and K-fittings are produced in a newly established production plant at Raufoss.



Material / Material

Isiflo va fi produs numai din bronz rezistent la dezincare RA 450 (DZR).

Isiflo will only be produced in dezincificated resistant brass RA 450 (DZR)!



Parteneri internationali / International partners

Raufoss Water & Gas AS s-a alaturat grupului Olandez Aalberts Industries NV, in 2004. Aceasta a crescut prezenta pe piata strategica Europeana. Raufoss Water & Gas AS a construit o vasta retea de distributie si de companii fice, agentii si distribuitori independenti si este reprezentata acum in 21 de tarii Europeene.

Raufoss Water & Gas AS joined the succesfull Dutch industrial group of Aalberts industries NV in 2004. This improves the presence in strategic markets throughout Europe. Raufoss Water & Gas AS has established a comprehensive distribution network of daughter companies, agents and independent distributors, and is currently represented in 21 European countries.



PROGRAMUL CUPLE BRONZ / BRASS COUPLINGS PROGRAM

Type 100 Cupla dreapta / Straight coupling

| NRF-nr | RWG-nr | ■ | ■ | ■ | ■ |
|-----------|---------|----------|----|----|-------|
| 256 10 22 | 6211001 | 16x16 mm | 10 | 80 | 0,175 |
| 256 10 24 | 6211002 | 20x20 mm | 10 | 80 | 0,220 |
| 256 10 29 | 6214003 | 25x25 mm | 10 | 80 | 0,275 |
| 256 10 34 | 6214004 | 32x32 mm | 10 | 40 | 0,425 |
| 256 10 39 | 6214005 | 40x40 mm | 5 | 20 | 0,840 |
| 256 10 44 | 6211006 | 50x50 mm | 4 | 8 | 1,070 |
| 256 11 62 | 6211007 | 63x63 mm | 3 | 6 | 2,200 |



Type 100 Cupla teava cupru / Coupling copper pipe

| NRF-nr | RWG-nr | ■ | ■ | ■ | ■ |
|-----------|---------|-------------|--------------|----|-------|
| 256 28 61 | 6212022 | 20x22 mm | 10 | 80 | 0,220 |
| 256 28 62 | 6212522 | 22mmx1" | Cu(25) 10 | 80 | 0,285 |
| 256 28 64 | 6212528 | 28mmx1" | Cu(25,4) 10 | 40 | 0,370 |
| 256 28 66 | 6216005 | 35mmx1 1/4" | Cu(31,8) 10 | 40 | 0,570 |
| 256 28 68 | 6216006 | 42mmx1 1/2" | Cu (38,1) 9 | 18 | 0,700 |
| 256 28 71 | 6216007 | 42mmx1 5/8" | CU (41,3) 10 | 20 | 0,590 |
| 256 28 73 | 6216008 | 42mmx1 3/4" | CU (44,5) 9 | 18 | 0,960 |
| 256 28 75 | 6216009 | 54mmx2" | CU (50,8) - | 14 | 1,310 |



Type 101 Cupla reparare / Repair coupling

| NRF-nr | RWG-nr | ■ | ■ | ■ | ■ |
|-----------|---------|----------|---|----|-------|
| 256 11 29 | 6211013 | 25x25 mm | 8 | 32 | 0,360 |
| 256 11 34 | 6211014 | 32x32 mm | 9 | 18 | 0,550 |
| 256 11 39 | 6211015 | 40x40 mm | 5 | 10 | 1,030 |
| 256 11 44 | 6211016 | 50x50 mm | 4 | 8 | 1,280 |
| 256 11 63 | 6211017 | 63x63 mm | 2 | 8 | 2,240 |



Type 105 Cupla Tata / Male coupling

| NRF-nr | RWG-nr | ■ | ■ | ■ | ■ |
|-----------|---------|-------------|----|-----|-------|
| 256 12 22 | 6211051 | 16mmx1/2" | 10 | 160 | 0,110 |
| 256 12 24 | 6211052 | 20mmx3/4" | 10 | 160 | 0,150 |
| 256 12 29 | 6211053 | 25mmx1" | 10 | 80 | 0,200 |
| 256 12 34 | 6211054 | 32mmx1 1/4" | 10 | 40 | 0,320 |
| 256 12 39 | 6211055 | 40mmx1 1/2" | 10 | 40 | 0,540 |
| 256 12 44 | 6211056 | 50mmx2" | 8 | 20 | 0,780 |



Type 110 Cupla Tata / Male coupling

| NRF-nr | RWG-nr | ■ | ■ | ■ | ■ |
|-----------|---------|-------------|----|-----|-------|
| 256 14 24 | 6214102 | 20mmx1/2" | 10 | 160 | 0,130 |
| 256 46 26 | 6212234 | 22mmx3/4" | 10 | 80 | 0,180 |
| 256 14 29 | 6214103 | 25mmx3/4" | 10 | 80 | 0,180 |
| 256 14 34 | 6214104 | 32mmx1" | 10 | 80 | 0,280 |
| 256 14 39 | 6214105 | 40mmx1 1/4" | 10 | 40 | 0,530 |
| 256 14 44 | 6211106 | 50mmx1.1/2" | 8 | 16 | 0,720 |
| 256 11 64 | 6211107 | 63mmx2" | - | 10 | 1,300 |



PROGRAMUL CUPLE BRONZ / BRASS COUPLINGS PROGRAM

Type 110 Cupla Mama-Tata / Male/female coupling

| NRF-nr | RWG-nr | ■ | ■ | ■ | ■ |
|-----------|---------|-------------------------------------|-------------------------------------|--------------------------------------|--------------------------------------|
| 256 14 59 | 6212101 | 75mm x 2 1/2"-2" | 1 | - | 0,280 |
| 256 14 64 | 6212102 | 75mm x 3"-2 1/2" | 1 | - | 0,260 |
| 256 14 69 | 6212103 | 90mm x 3"-2 1/2" | 1 | - | 0,295 |



Type 112 Cupla Tata / Male coupling

| NRF-nr | RWG-nr | ■ | ■ | ■ | ■ |
|-----------|---------|-------------------------------------|-------------------------------------|--------------------------------------|--------------------------------------|
| 256 15 26 | 6211123 | 25mm x 1/2" | 10 | 80 | 0,170 |
| 256 15 34 | 6211124 | 32mm x 3/4" | 10 | 80 | 0,270 |
| 256 15 39 | 6211125 | 40mm x 1" | 10 | 40 | 0,500 |
| 256 15 44 | 6211128 | 50mm x 1 1/4" | 8 | 16 | 0,680 |
| 256 11 65 | 6211127 | 63mm x 1 1/2" | 4 | 8 | 1,250 |



Type 115 Cupla Mama / Female coupling

| NRF-nr | RWG-nr | ■ | ■ | ■ | ■ |
|-----------|---------|-------------------------------------|-------------------------------------|--------------------------------------|--------------------------------------|
| 256 16 22 | 6211151 | 16mm x 1/2" | 10 | 160 | 0,115 |
| 256 16 24 | 6211152 | 20mm x 3/4" | 10 | 80 | 0,180 |
| 256 16 29 | 6211153 | 25mm x 1" | 10 | 80 | 0,240 |
| 256 16 34 | 6211154 | 32mm x 1 1/4" | 10 | 40 | 0,360 |
| 256 16 39 | 6211155 | 40mm x 1 1/2" | 10 | 20 | 0,630 |
| 256 16 44 | 6211156 | 50mm x 2" | 8 | 16 | 0,860 |



Type 116 Cupla Mama / Female coupling

| NRF-nr | RWG-nr | ■ | ■ | ■ | ■ |
|-----------|---------|-------------------------------------|-------------------------------------|--------------------------------------|--------------------------------------|
| 256 17 24 | 6214162 | 20mm x 1/2" | 10 | 160 | 0,130 |
| 256 17 26 | 6218052 | 25mm x 1/2" | 10 | 160 | 0,170 |
| 256 17 29 | 6214163 | 25mm x 3/4" | 10 | 160 | 0,170 |
| 256 17 34 | 6211161 | 32mm x 3/4" | 10 | 80 | 0,310 |
| 256 17 39 | 6214164 | 32mm x 1" | 10 | 80 | 0,270 |
| 256 17 44 | 6211168 | 40mm x 1" | 10 | 40 | 0,470 |
| 256 17 49 | 6214165 | 40mm x 1 1/4" | 10 | 40 | 0,525 |
| 256 17 54 | 6211169 | 50mm x 1 1/4" | 8 | 16 | 0,680 |
| 256 17 59 | 6211166 | 50mm x 1 1/2" | 8 | 16 | 0,655 |
| 256 11 66 | 6211167 | 63mm x 2" | - | 10 | 1,330 |



Type 100 Otel galvanizat / Galv.steel

| NRF-nr | RWG-nr | ■ | ■ | ■ | ■ |
|-----------|---------|-------------------------------------|-------------------------------------|--------------------------------------|--------------------------------------|
| 256 45 25 | 6217232 | 21 x 21mm | 10 | 80 | 0,190 |
| 256 45 32 | 6217233 | 27 x 27mm | 10 | 80 | 0,270 |
| 256 45 35 | 6217234 | 34 x 34mm | 10 | 40 | 0,360 |
| 256 45 41 | 6217235 | 42 x 42mm | 10 | 20 | 0,700 |
| 256 45 44 | 6217236 | 49 x 49mm | 6 | 12 | 0,870 |
| 256 45 57 | 6217237 | 60 x 60mm | - | 12 | 1,400 |



PROGRAMUL CUPLE BRONZ / BRASS COUPLINGS PROGRAM

Gammel standard / imperial standard

Type 110 Cupla Tata / Male coupling

| NRF-nr | RWG-nr | ■ | ■ | ■ | ■ |
|-----------|---------|-------------------------------------|-------------------------------------|--------------------------------------|--------------------------------------|
| 256 46 25 | 6217212 | 21mm x 1/2" | 10 | 160 | 0,130 |
| 256 46 32 | 6217213 | 27mm x 3/4" | 10 | 80 | 0,160 |
| 256 46 35 | 6217214 | 34mm x 1" | 10 | 80 | 0,230 |
| 256 46 41 | 6217215 | 42mm x 1 1/4" | 10 | 40 | 0,370 |
| 256 46 44 | 6217216 | 49mm x 1 1/2" | 8 | 16 | 0,580 |
| 256 46 57 | 6217217 | 60mm x 2" | 4 | 8 | 0,920 |

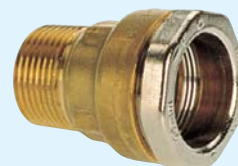

Gammel standard / imperial standard

Type 116 Cupla Mama / Female coupling

| NRF-nr | RWG-nr | ■ | ■ | ■ | ■ |
|-----------|---------|-------------------------------------|-------------------------------------|--------------------------------------|--------------------------------------|
| 256 47 25 | 6217221 | 21mm x 1/2" | 10 | 160 | 0,130 |
| 256 47 32 | 6217223 | 27mm x 3/4" | 10 | 80 | 0,160 |
| 256 47 35 | 6217224 | 34mm x 1" | 10 | 80 | 0,250 |
| 256 47 41 | 6217225 | 42mm x 1 1/4" | 10 | 40 | 0,370 |
| 256 47 44 | 6217226 | 49mm x 1 1/2" | 8 | 16 | 0,550 |
| 256 47 57 | 6217227 | 60mm x 2" | 4 | 8 | 0,910 |



Gammel standard / imperial standard

Type 100 Otel galvanizat / Galv. steel

| NRF-nr | RWG-nr | ■ | ■ | ■ | ■ |
|-----------|---------|-------------------------------------|-------------------------------------|--------------------------------------|--------------------------------------|
| 256 10 64 | 6217202 | 21x20 mm (1/2") | 10 | 80 | 0,200 |
| 256 10 67 | 6217203 | 27x25 mm (3/4") | 10 | 40 | 0,410 |
| 256 10 71 | 6217204 | 34x32 mm (1") | 10 | 20 | 0,670 |
| 256 10 74 | 6217205 | 42x40 mm (1.1/4") | 9 | 18 | 1,040 |
| 256 10 77 | 6217206 | 49x50 mm (1.1/2") | 5 | 10 | 1,500 |
| 256 11 61 | 6217208 | 60x63 mm (2") | 3 | 12 | 1,910 |



Type 120 Cot 90° / Elbow 90°

| NRF-nr | RWG-nr | ■ | ■ | ■ | ■ |
|-----------|---------|-------------------------------------|-------------------------------------|--------------------------------------|--------------------------------------|
| 256 19 24 | 6211202 | 20x20 mm | 10 | 80 | 0,250 |
| 256 19 29 | 6211203 | 25x25 mm | 10 | 80 | 0,300 |
| 256 19 34 | 6211204 | 32x32 mm | 10 | 40 | 0,530 |
| 256 19 39 | 6211205 | 40x40 mm | 5 | 10 | 1,100 |
| 256 19 44 | 6211206 | 50x50 mm | - | 8 | 1,330 |
| 256 11 67 | 6211207 | 63x63 mm | - | 8 | 2,960 |



Type 121 Cot 90° Tata / Elbow 90°, male iron

| NRF-nr | RWG-nr | ■ | ■ | ■ | ■ |
|-----------|---------|-------------------------------------|-------------------------------------|--------------------------------------|--------------------------------------|
| 256 20 24 | 6210212 | 20mmx1/2" | 10 | 80 | 0,170 |
| 256 20 29 | 6214613 | 25mmx3/4" | 10 | 80 | 0,310 |
| 256 20 34 | 6214614 | 32mmx1" | 5 | 40 | 0,410 |
| 256 20 35 | 6211214 | 32mmx1 1/4" | 5 | 40 | 0,580 |
| 256 20 39 | 6210215 | 40mmx1 1/4" | 5 | 20 | 0,800 |
| 256 20 41 | 6211215 | 42mmx1 1/2" | 5 | 20 | 0,965 |
| 256 20 44 | 6210216 | 50mmx1 1/2" | 6 | 12 | 1,390 |
| 256 20 45 | 6211216 | 50mmx2" | 6 | 12 | 1,390 |
| 256 11 68 | 6211217 | 63mmx2" | 2 | 8 | 1,970 |



PROGRAMUL CUPLE BRONZ / BRASS COUPLINGS PROGRAM

Type 122 Cot 90° Mama / Elbow, female iron

| NRF-nr | RWG-nr | ■ | ■ | ■ | ■ |
|-----------|---------|---------------|----|----|-------|
| 256 21 24 | 6211222 | 20mm x 1/2" | 10 | 80 | 0,160 |
| 256 21 26 | 6218049 | 25mm x 1/2" | 10 | 80 | 0,220 |
| 256 21 29 | 6214223 | 25mm x 3/4" | 10 | 40 | 0,370 |
| 256 21 31 | 6218050 | 32mm x 3/4" | 5 | 20 | 0,660 |
| 256 21 34 | 6211224 | 32mm x 1" | 5 | 20 | 0,940 |
| 256 21 38 | 6218060 | 40mm x 1" | 9 | 18 | 1,480 |
| 256 21 39 | 6211225 | 40mm x 1 1/4" | 5 | 10 | 0,680 |
| 256 21 42 | 6218051 | 50mm x 1 1/4" | 4 | 16 | 0,990 |
| 256 21 44 | 6211226 | 50mm x 1 1/2" | | 16 | 1,000 |
| 256 11 69 | 6211227 | 63mm x 2" | 2 | 8 | 1,800 |



Type 123 Cot 45° / Elbow 45°

| NRF-nr | RWG-nr | ■ | ■ | ■ | ■ |
|-----------|---------|----------|----|----|-------|
| 256 22 29 | 6211233 | 25x25 mm | 10 | 80 | 0,290 |
| 256 22 34 | 6211234 | 32x32 mm | 10 | 40 | 0,500 |
| 256 22 39 | 6211235 | 40x40 mm | 5 | 20 | 0,880 |
| 256 22 44 | 6211236 | 50x50 mm | 3 | 12 | 1,210 |
| 256 11 71 | 6211237 | 63x63 mm | - | 10 | 2,240 |



Type 124 Cot 90° Tata / Elbow 90° male iron

| NRF-nr | RWG-nr | ■ | ■ | ■ | ■ |
|-----------|---------|---------------|----|----|-------|
| 256 23 29 | 6211243 | 25mm x 1/2" | 10 | 80 | 0,220 |
| 256 23 34 | 6211244 | 32mm x 3/4" | 5 | 40 | 0,310 |
| 256 23 39 | 6211245 | 40mm x 1" | 8 | 16 | 0,630 |
| 256 23 44 | 6211246 | 50mm x 1 1/4" | 4 | 16 | 1,030 |
| 256 11 72 | 6211247 | 63mm x 1 1/2" | - | 8 | 1,890 |



Type 129 Cot 90° pivotant / Swivel Elbow 90°

| NRF-nr | RWG-nr | ■ | ■ | ■ | ■ |
|-----------|---------|---------------|----|----|-------|
| 256 24 85 | 6211293 | 32mm x 1 1/4" | 10 | 20 | 0,730 |
| 256 24 87 | 6211295 | 40mm x 1 1/4" | 5 | 10 | 1,120 |
| 256 24 89 | 6211290 | 40mm x 1 1/2" | 5 | 20 | 1,200 |
| 256 24 94 | 6211294 | 50mm x 1 1/2" | - | 15 | 1,400 |
| | | 63mm x 2" | | | |



Type 229 Cot dublu pivotant / Double Swivel Elbow

| NRF-nr | RWG-nr | ■ | ■ | ■ | ■ |
|-----------|---------|---------------|---|----|-------|
| 256 30 92 | 6212292 | 32mm x 1 1/4" | 5 | 10 | 0,190 |
| 256 30 91 | 6212293 | 32mm x 1 1/2" | 5 | 10 | 0,270 |
| 256 30 94 | 6212291 | 40mm x 1 1/4" | 3 | 6 | 0,360 |
| 256 30 96 | 6212298 | 40mm x 1 1/2" | 3 | 6 | 0,700 |
| 256 30 97 | 6212295 | 50mm x 1 1/4" | - | 10 | 0,870 |
| 256 30 98 | 6212294 | 50mm x 1 1/2" | - | 10 | 2,100 |
| 256 30 93 | 6212299 | 63mm x 2" | - | 5 | 3,030 |



ISIFLO MESSINGPROGRAM / BRASS COUPLINGS PROGRAM

Type 200 Bakkekran / Gate valve

| NRF-nr | RWG-nr | ■ | ■ | ■ | ■ |
|-----------|---------|-------------------------------------|-------------------------------------|--------------------------------------|--------------------------------------|
| 338 36 04 | 6216025 | 25x25 mm | - | 10 | 1,670 |
| 338 36 06 | 6216032 | 32x32 mm | - | 10 | 1,975 |
| 338 36 08 | 6216040 | 40x40 mm | - | 8 | 2,470 |
| 338 36 11 | 6216050 | 50x50 mm | - | 5 | 4,300 |
| 338 36 13 | 6216063 | 63x63 mm | - | 4 | 4,660 |



Type 125 T-rør / Tee

| NRF-nr | RWG-nr | ■ | ■ | ■ | ■ |
|-----------|---------|-------------------------------------|-------------------------------------|--------------------------------------|--------------------------------------|
| 256 24 22 | 6211251 | 16x16x16 mm | 10 | 80 | 0,255 |
| 256 24 24 | 6211252 | 20x20x20 mm | 10 | 40 | 0,350 |
| 256 24 29 | 6214253 | 25x25x25 mm | 10 | 40 | 0,450 |
| 256 24 34 | 6214254 | 32x32x32 mm | 3 | 14 | 0,725 |
| 256 24 39 | 6214255 | 40x40x40 mm | - | 12 | 1,460 |
| 256 24 44 | 6211256 | 50x50x50 mm | - | 6 | 1,900 |
| 256 11 73 | 6211257 | 63x63x63 mm | - | 6 | 4,070 |



Type 130 T-rør m. reduksjon i avstikk / Tee reduced

| NRF-nr | RWG-nr | ■ | ■ | ■ | ■ |
|-----------|---------|-------------------------------------|-------------------------------------|--------------------------------------|--------------------------------------|
| 256 25 29 | 6211300 | 25x20x25 mm | 10 | 40 | 0,470 |
| 256 25 34 | 6211304 | 32x25x32 mm | 5 | 20 | 0,850 |
| 256 25 39 | 6211305 | 40x32x40 mm | 4 | 8 | 1,200 |
| 256 25 44 | 6211308 | 50x32x50 mm | 3 | 12 | 1,650 |
| 256 25 49 | 6211306 | 50x40x50 mm | - | 6 | 1,700 |
| 256 11 75 | 6211309 | 63x32x63 mm | - | 5 | 2,940 |
| 256 11 74 | 6211307 | 63x40x63 mm | - | 4 | 3,200 |



Type 131 T-rør m. utv. rørgj. i avstikk / Tee, male branch

| NRF-nr | RWG-nr | ■ | ■ | ■ | ■ |
|-----------|---------|-------------------------------------|-------------------------------------|--------------------------------------|--------------------------------------|
| 256 26 24 | 6211312 | 20x1/2" x 20mm | 10 | 80 | 0,270 |
| 256 26 29 | 6211313 | 25x3/4" x 25mm | 10 | 40 | 0,330 |
| 256 26 34 | 6211314 | 32x1" x 32mm | 10 | 40 | 0,560 |
| 256 26 39 | 6211315 | 40x1 1/4" x 40mm | 4 | 8 | 1,020 |
| 256 26 44 | 6211316 | 50x1 1/2" x 50mm | 4 | 8 | 1,460 |
| 256 11 76 | 6211317 | 63x2" x 63mm | - | 8 | 3,120 |



Type 132 T-rør m. innv. rørgj. i avstikk / Tee, female branch

| NRF-nr | RWG-nr | ■ | ■ | ■ | ■ |
|-----------|---------|-------------------------------------|-------------------------------------|--------------------------------------|--------------------------------------|
| 256 27 24 | 6211322 | 20x1/2" x 20mm | 10 | 80 | 0,240 |
| 256 27 29 | 6211323 | 25x3/4" x 25mm | 10 | 40 | 0,320 |
| 256 27 34 | 6211324 | 32x1" x 32mm | 10 | 40 | 0,550 |
| 256 27 39 | 6211325 | 40x1 1/4" x 40mm | 4 | 8 | 1,000 |
| 256 27 44 | 6211326 | 50x1 1/2" x 50mm | 3 | 6 | 1,600 |
| 256 11 77 | 6211327 | 63x2" x 63mm | - | 8 | 2,920 |



PROGRAMUL CUPLE BRONZ / BRASS COUPLINGS PROGRAM

Type 135 Niplu redus 1 treapta / Reducer, single step

| NRF-nr | RWG-nr | | | | |
|-----------|---------|----------|----|-----|-------|
| 256 28 29 | 6211353 | 25x20 mm | 10 | 160 | 0,090 |
| 256 28 34 | 6211354 | 32x25 mm | 10 | 80 | 0,155 |
| 256 28 39 | 6211355 | 40x32 mm | 10 | 80 | 0,260 |
| 256 28 44 | 6211356 | 50x40 mm | 10 | 40 | 0,370 |
| 256 11 78 | 6211358 | 63x50 mm | 5 | 10 | 1,015 |



Type 140 Niplu redus 2 trepte / Reducer, double step

| NRF-nr | RWG-nr | | | | |
|-----------|---------|----------|----|-----|-------|
| 256 29 29 | 6211403 | 25x16 mm | 10 | 160 | 0,060 |
| 256 29 34 | 6211404 | 32x20 mm | 10 | 80 | 0,180 |
| 256 29 39 | 6211405 | 40x25 mm | 10 | 80 | 0,290 |
| 256 29 42 | 6211408 | 40x38 mm | 10 | 40 | 0,500 |
| 256 29 44 | 6211406 | 50x32 mm | 10 | 40 | 0,445 |
| 256 11 79 | 6211409 | 63x40 mm | 5 | 10 | 1,170 |
| 256 28 55 | 6211410 | 63x57 mm | 5 | 10 | 0,800 |



Type 142 Adaptor teava Otel / Adaptor for steel pipes

| NRF-nr | RWG-nr | | | | |
|-----------|---------|---------------|----|----|-------|
| 256 29 65 | 6211423 | 25mm x 3/4" | 10 | 80 | 0,270 |
| 256 29 67 | 6211424 | 32mm x 1" | 10 | 40 | 0,365 |
| 256 29 69 | 6211425 | 40mm x 1 1/4" | 10 | 40 | 0,500 |
| 256 29 73 | 6211426 | 50mm x 1 1/2" | 10 | 40 | 0,600 |
| 256 11 81 | 6211428 | 63mm x 2" | 5 | 10 | 1,040 |



Type 144 Niplu dublu / Double connecting nipple

| NRF-nr | RWG-nr | | | | |
|-----------|---------|------------|----|-----|-------|
| 256 31 31 | 6218043 | 25 x 25 mm | 10 | 160 | 0,150 |
| 256 31 34 | 6218048 | 32 x 32mm | 10 | 80 | 0,210 |
| 256 31 39 | 6218044 | 40 x 40mm | 10 | 80 | 0,300 |
| 256 31 44 | 6218045 | 50 x 50mm | 10 | 20 | 0,430 |
| 256 11 82 | 6211447 | 63 x 63mm | 10 | 20 | 0,850 |



Type 143 Niplu dublu pivotant / Swivel double nipple

| NRF-nr | RWG-nr | | | | |
|-----------|---------|-----------|---|----|-------|
| 256 30 76 | 6211434 | 32 x 32mm | 5 | 40 | 0,260 |
| 256 30 78 | 6211435 | 40 x 40mm | 5 | 20 | 0,710 |



PROGRAMUL CUPLE BRONZ / BRASS COUPLINGS PROGRAM

Type 145 Dop / Blanking plug

| NRF-nr | RWG-nr | ■ | ■ | ■ | ■ |
|-----------|---------|-------------------------------------|-------------------------------------|--------------------------------------|--------------------------------------|
| 256 32 22 | 6211451 | 16 mm | 10 | 160 | 0,010 |
| 256 32 24 | 6211452 | 20 mm | 10 | 160 | 0,018 |
| 256 32 29 | 6211453 | 25 mm | 10 | 160 | 0,022 |
| 256 32 34 | 6211454 | 32 mm | 10 | 160 | 0,050 |
| 256 32 39 | 6211455 | 40 mm | 10 | 160 | 0,078 |
| 256 32 44 | 6211456 | 50 mm | 10 | 160 | 0,110 |
| 256 11 83 | 6211458 | 63 mm | 10 | 80 | 0,260 |



Type 146 Niplu Tata / Connecting male nipple

| NRF-nr | RWG-nr | ■ | ■ | ■ | ■ |
|-----------|---------|-------------------------------------|-------------------------------------|--------------------------------------|--------------------------------------|
| 256 33 24 | 6211462 | 20 mm x 3/4" | 10 | 160 | 0,080 |
| 256 33 29 | 6211463 | 25 mm x 1 | 10 | 160 | 0,110 |
| 256 33 34 | 6211464 | 32 mm x 1 1/4" | 10 | 80 | 0,182 |
| 256 33 39 | 6211465 | 40 mm x 1 1/2" | 10 | 40 | 0,268 |
| 256 33 44 | 6211466 | 50 mm x 2 | 10 | 40 | 0,322 |



Type 147 Niplu Tata / Connecting male nipple

| NRF-nr | RWG-nr | ■ | ■ | ■ | ■ |
|-----------|---------|-------------------------------------|-------------------------------------|--------------------------------------|--------------------------------------|
| 256 34 24 | 6211472 | 20 mm x 1/2" | 10 | 160 | 0,080 |
| 256 34 29 | 6211473 | 25 mm x 3/4" | 10 | 160 | 0,110 |
| 256 34 34 | 6211474 | 32 mm x 1" | 10 | 80 | 0,190 |
| 256 34 39 | 6211475 | 40 mm x 1 1/4" | 10 | 40 | 0,280 |
| 256 34 44 | 6211476 | 50 mm x 1 1/2" | 10 | 40 | 0,372 |
| 256 11 84 | 6211478 | 63 mm x 2" | 10 | 20 | 0,910 |



Type 148 Niplu Mama / Connecting female nipple

| NRF-nr | RWG-nr | ■ | ■ | ■ | ■ |
|-----------|---------|-------------------------------------|-------------------------------------|--------------------------------------|--------------------------------------|
| 256 35 22 | 6211480 | 16 mm x 3/8" | 10 | 160 | 0,030 |
| 256 35 24 | 6211482 | 20 mm x 1/2" | 10 | 160 | 0,045 |
| 256 35 29 | 6211483 | 25 mm x 3/4" | 10 | 160 | 0,085 |
| 256 35 34 | 6211484 | 32 mm x 1" | 10 | 160 | 0,150 |
| 256 35 39 | 6211485 | 40 mm x 1 1/4" | 10 | 80 | 0,165 |
| 256 35 42 | 6211488 | 42 mm x 1 1/4" | 10 | 80 | 0,180 |
| 256 35 44 | 6211486 | 50 mm x 1 1/2" | 10 | 80 | 0,220 |
| 256 11 85 | 6211489 | 63 mm x 2" | 8 | 32 | 0,600 |



Type 149 Niplu Mama / Connecting female nipple

| NRF-nr | RWG-nr | ■ | ■ | ■ | ■ |
|-----------|---------|-------------------------------------|-------------------------------------|--------------------------------------|--------------------------------------|
| 256 36 24 | 6211492 | 20 mm x 3/8" | 10 | 160 | 0,060 |
| 256 36 29 | 6211493 | 25 mm x 1/2" | 10 | 160 | 0,100 |
| 256 36 34 | 6211494 | 32 mm x 3/4" | 10 | 80 | 0,160 |
| 256 36 39 | 6211495 | 40 mm x 1" | 10 | 60 | 0,350 |
| 256 36 44 | 6211496 | 50 mm x 1 1/4" | 10 | 40 | 0,380 |



PROGRAMUL CUPLE BRONZ / BRASS COUPLINGS PROGRAM

Type 150 Cot 90° fixare perete / Elbow 90°, wall fixing

| NRF-nr | RWG-nr | ■ | ■ | ■ | ■ |
|-----------|---------|-------------|---|----|-------|
| 256 37 22 | 6211501 | 16 mm x1/2" | 5 | 40 | 0,400 |
| 256 37 24 | 6211502 | 20 mm x1/2" | 5 | 40 | 0,370 |
| 256 37 29 | 6211504 | 25 mm x1/2" | 5 | 40 | 0,330 |
| 256 37 34 | 6211503 | 25 mm x3/4" | 5 | 40 | 0,310 |



Type 180 Insertie suport compozita SDR11 / Support insert compozit SDR11

| NRF-nr | RWG-nr | ■ | Rørdiam. x vegg Pipe diam. x wall | ■ | ■ | ■ |
|--------------------------|---------|---------------|--------------------------------------|-----|-------|---|
| SDR 11 vann/water | | | | | | |
| 256 40 24 | 6211802 | 20mm x 1.9 mm | 10 | 200 | 0,004 | |
| 256 40 29 | 6211803 | 25mm x 2.3 mm | 20 | 200 | 0,006 | |
| 256 40 34 | 6211804 | 32mm x 3.0 mm | 50 | 200 | 0,011 | |
| 256 40 39 | 6211805 | 40mm x 3.7 mm | 20 | 100 | 0,028 | |
| 256 40 44 | 6211806 | 50mm x 4.6 mm | 10 | 100 | 0,045 | |
| 256 40 54 | 6211807 | 63mm x 5.8 mm | 10 | 50 | 0,069 | |
| SDR 11 gass/gas | | | | | | |
| 256 40 62 | 6211808 | 20mm x 3.0 mm | 1 | - | - | |
| 256 40 63 | 6211809 | 25mm x 3.0 mm | 1 | - | 0,015 | |



Type 181 Insertie suport SDR 17,6 / Support insert SDR 17,6

| NRF-nr | RWG-nr | ■ | Rørdiam. x vegg Pipe diam. x wall | ■ | ■ | ■ |
|----------------------------|---------|---------------|--------------------------------------|---|-------|---|
| SDR 17,6 vann/water | | | | | | |
| | 6211813 | 25mm x 1.8 mm | 1 | - | 0,015 | |
| 256 40 56 | 6211814 | 32mm x 2.0 mm | 1 | - | 0,028 | |
| 256 40 57 | 6211815 | 40mm x 2.3 mm | 1 | - | 0,034 | |
| 256 40 58 | 6211816 | 50mm x 2.9 mm | 1 | - | 0,082 | |
| SDR 17,6 gass/gas | | | | | | |
| | 6211810 | 20mm x 2,3 mm | 1 | - | - | |
| | 6211811 | 25mm x 2,3 mm | 1 | - | - | |
| | 6211812 | 32mm x 2.3 mm | 1 | - | - | |



Type 330 Ax Galvanizat / Spindle

| NRF-nr | RWG-nr | ■ | ■ | ■ | ■ |
|-----------|-----------|---------------|---|---|-------|
| 335 24 94 | 621 60 74 | 0,50 - 0,90 m | 1 | - | 4,000 |
| 335 24 96 | 621 60 75 | 0,82 - 1,38 m | 1 | - | 4,500 |
| 335 24 98 | 621 60 76 | 1,10 - 1,85 m | 1 | - | 5,000 |
| 335 25 01 | 621 60 77 | 1,37 - 2,30 m | 1 | - | 5,000 |
| 335 25 03 | 621 60 78 | 1,90 - 3,50 m | 1 | - | 8,000 |



Type 350 Vana trecere cu tija telescopica / Gate valve with telescopic spindle

| NRF-nr | RWG-nr | ■ | ■ | ■ | ■ |
|-----------|-----------|-----------|---|---|-------|
| 335 24 22 | 621 60 80 | D=250mm | 1 | - | 4,200 |
| 335 24 24 | 621 60 81 | 185x185mm | 1 | - | 4,400 |



PROGRAMUL CUPLE BRONZ / BRASS COUPLINGS PROGRAM

Type 1294 Tub flexibil / Flexible hose

| NRF-nr | RWG-nr | ■ | ■ | ■ | ■ |
|-----------|---------|-------------------------------------|-------------------------------------|--------------------------------------|--------------------------------------|
| 338 36 26 | 6216201 | 40 x 40 mm L=525 | 1 | - | 1,690 |
| 338 36 28 | 6216202 | 40 x 40 mm L=1000m | 1 | - | 2.290 |



Type 210 Scule / Tools

| NRF-nr | RWG-nr | ■ | ■ | ■ | ■ |
|-----------|---------|-------------------------------------|-------------------------------------|--------------------------------------|--------------------------------------|
| 335 24 11 | 6216079 | H=0,75m | 1 | - | 1,200 |



Type 151 Piesa trecere Beton / Concrete transition

| NRF-nr | RWG-nr | ■ | ■ | ■ | ■ |
|-----------|---------|-------------------------------------|-------------------------------------|--------------------------------------|--------------------------------------|
| 256 69 01 | 6211508 | 151-25x3/4"x1 1/2" | 1 | 10 | 0,380 |
| 256 69 03 | 6211509 | 151-32x3/4"x2" | 1 | 10 | 0,490 |
| 256 69 05 | 6211514 | 151-32x1"x2" | 1 | 10 | 0,500 |
| 256 69 07 | 6211515 | 151-40x1"x2" | 1 | 10 | 0,590 |
| 256 69 09 | 6211516 | 151-40x1 1/4"x2" | 1 | 10 | 0,620 |



Type 152 Piesa trecere Beton / Concrete transition

| NRF-nr | RWG-nr | ■ | ■ | ■ | ■ |
|-----------|---------|-------------------------------------|-------------------------------------|--------------------------------------|--------------------------------------|
| 256 69 23 | 6211524 | 152-32x1"x2" | 1 | 10 | 0,520 |
| 256 69 25 | 6211525 | 152-40x1"x2" | 1 | 10 | 0,605 |
| 256 69 27 | 6211526 | 152-40x1 1/4"x2" | 1 | 10 | 0,615 |



Type 170+105, 110+112 Piesa trecere Beton / Concrete transition

| NRF-nr | RWG-nr | ■ | ■ | ■ | ■ |
|-----------|---------|-------------------------------------|-------------------------------------|--------------------------------------|--------------------------------------|
| 256 69 33 | 6211510 | 110-32x1"x2" | 1 | 10 | 0,520 |
| 256 69 35 | 6211511 | 105-32x1 1/4"x2" | 1 | 10 | 0,650 |
| 256 69 37 | 6211512 | 112-40x1"x2 1/2" | 1 | 5 | 0,835 |
| 256 69 39 | 6211513 | 110-40x1 1/4"x2 1/2" | 1 | 5 | 0,865 |
| 256 69 42 | 6211517 | 112-50x1 1/4"x3" | 1 | 15 | 1,010 |
| 256 69 44 | 6211518 | 110-50x1 1/2"x3" | 1 | 15 | 1,155 |
| 256 69 46 | 6211519 | 110-63x2"x3 1/2" | 1 | 25 | 1,270 |



PROGRAMUL CUPLE BRONZ / BRASS COUPLINGS PROGRAM

Type 170+116 Piesa trecere Beton / Concrete transition

| NRF-nr | RWG-nr | ■ | ■ | ■ | ■ |
|-----------|---------|----------------------|----|----|-------|
| 256 69 53 | 6211520 | 116-32x1"x2" | 10 | 40 | 0,530 |
| 256 69 55 | 6211522 | 116-40x1"x2 1/2" | 5 | 20 | 0,860 |
| 256 69 57 | 6211523 | 116-40x1 1/4"x2 1/2" | 5 | 20 | 0,870 |
| 256 69 59 | 6211527 | 116-50x1 1/4"x3" | 1 | 20 | 1,100 |
| 256 69 62 | 6211528 | 116-50x1 1/2"x3" | 1 | 15 | 1,160 |
| 256 69 64 | 6211529 | 116-63x2"x3 1/2" | 1 | 10 | 1,820 |



Type 179 Teava - 1m / Pipe - 1m

| NRF-nr | RWG-nr | ■ | ■ | ■ | ■ |
|-----------|---------|---------------|---|---|-------|
| 256 69 83 | 6212794 | 179-32x2" | 1 | - | 1,650 |
| 256 69 85 | 6212795 | 179-40x2 1/2" | 1 | - | 1,570 |
| 256 69 87 | 6212796 | 179-50x3" | 1 | - | 2,060 |
| 256 69 89 | 6212797 | 179-63x3 1/2" | 1 | - | 4,410 |



Type 179 Teava - 450mm / Pipe - 450mm

| NRF-nr | RWG-nr | ■ | ■ | ■ | ■ |
|-----------|---------|---------------|---|---|-------|
| 256 69 73 | 6211794 | 179-32x2" | 1 | - | 0,680 |
| 256 69 75 | 6211795 | 179-40x2 1/2" | 1 | - | 0,700 |
| 256 69 77 | 6211796 | 179-50x3" | 1 | - | 0,970 |
| 256 69 79 | 6211797 | 179-63x3 1/2" | 1 | - | 1,840 |



Type 1298 Set reparatie / Repair set complete

| NRF-nr | RWG-nr | ■ | ■ | ■ | ■ |
|-----------|---------|---|---|---|---|
| 256 74 31 | 6211603 | | 1 | - | - |



Type Piulita / Nut

| NRF-nr | RWG-nr | ■ | ■ | ■ | ■ |
|-----------|---------|----------|---|---|-------|
| | 3054601 | 16mm | 1 | - | 0,040 |
| 256 75 24 | 3054602 | 20mm | 1 | - | 0,050 |
| 256 75 29 | 3054603 | 25mm | 1 | - | 0,070 |
| 256 75 34 | 3054604 | 32mm | 1 | - | 0,100 |
| 256 75 39 | 3054605 | 40mm | 1 | - | 0,245 |
| 256 75 44 | 3054606 | 50mm | 1 | - | 0,320 |
| 256 75 86 | 3054647 | 63mm | 1 | - | 0,430 |
| 256 11 86 | 3056617 | 63mm new | 1 | - | 0,595 |



PROGRAMUL CUPLE BRONZ / BRASS COUPLINGS PROGRAM

Type Inel presiune / Pressure ring

| NRF-nr | RWG-nr | ■ | ■ | ■ | ■ |
|-----------|---------|------|---|---|---|
| 256 77 24 | 3059020 | 20mm | | | |
| 256 77 29 | 3059025 | 25mm | | | |
| 256 77 34 | 3059032 | 32mm | | | |
| 256 77 39 | 3059040 | 40mm | | | |
| 256 77 44 | 3059050 | 50mm | | | |
| 256 77 54 | 3059063 | 63mm | | | |



Type Inel strangere / Clamp ring

| NRF-nr | RWG-nr | ■ | ■ | ■ | ■ |
|-----------|---------|------|---|---|---|
| | 3059416 | 16mm | | | |
| 256 76 24 | 3059420 | 20mm | | | |
| 256 76 29 | 3059425 | 25mm | | | |
| 256 76 34 | 3059432 | 32mm | | | |
| 256 76 39 | 3059440 | 40mm | | | |
| 256 76 44 | 3059450 | 50mm | | | |
| 256 11 87 | 3056618 | 63mm | | | |



Type Garnitura / O-ring

| NRF-nr | RWG-nr | ■ | ■ | ■ | ■ |
|-----------|---------|------|---|---|---|
| | 3059216 | 16mm | | | |
| 256 78 24 | 3059220 | 20mm | | | |
| 256 78 29 | 3059225 | 25mm | | | |
| 256 78 34 | 3059232 | 32mm | | | |
| 256 78 39 | 3059240 | 40mm | | | |
| 256 78 44 | 3059250 | 50mm | | | |
| 256 78 54 | 3059263 | 63mm | | | |



Isiflo Chei

| NRF-nr | RWG-nr | ■ | ■ | ■ | ■ |
|-----------|---------|------------|---|---|---|
| 256 73 71 | 6211941 | 20 + 25 mm | | | |
| 256 73 72 | 6211942 | 32 + 40 mm | | | |
| 256 73 73 | 6211943 | 50 + 63 mm | | | |
| 256 73 78 | 6211940 | Nøkkelsett | | | |



Aprobari:

Fitingurile sunt listate WRAS, pentru a fi folosite in lucrari supraterane si subterane (dimensiunile 50 si 63 mm sunt aprobate cu aliniator).

Alte aprobari: DVGW, KIWA, GASTEC, ETA, SITAC, ISO 9001.

Aplicatii:

Cuplajele Isiflo pentru tevi din plastic ofera un montaj deosebit de rezistent si pot fi folosite pentru:

- MDPE: BS6572 si BS6730
- Polietilena neagra: toate calitatile si BS3284
- Cupru: tabelul X & Y
- Plumb: BS602 si BS1085
- Otel galvanizat: BS1387, BS3601, si BS3602, par. 1 & 2. (doar tipul 142)
- PVC: BS3505

Materiale:

- De la 16 la 63mm: bronz rezistent la dezincare
- De la 75 la 180mm: Fonta ductila acoperita cu vopsea epoxidica.
- Garnituri: NBR.
- Bolturi: otel inox de inalta calitate A4.

Domeniul de aplicabilitate:

- Apa rece sau potabila sub 40°C
- Gaz (cu suport de tip 180)

Presiunea de lucru:

- Apa pana la 16 bar.
- Gaz pana la 10 bar (cu suport de tip 180)
- Aer pana la 10 bar.

Diverse

- Suporta motorina si petrol
- Contacteaza producatorul pentru alte intrebari.

Toate informatiile sunt bazate pe piata UK. Pentru mai multe detalii despre alte tarii, va rugam sa contactati departamentul nostru de vanzari.

Approvals UK:

The fittings are WRAS listed for use without insert for above and below ground applications (50 and 63 mm is approved with liner).

Other approvals: DVGW, KIWA, WRC, GASTEC, ETA, SITAC, ISO 9001.

Applications:

Isiflo coupling system for plastic pipes gives a tight and end-load resistant connection and can be used on:

- MDPE: BS6572 and BS6730
- Black poly: All classes, and BS3284
- Copper: Table X & Y
- Lead: BS602 and BS1085
- Galvanised steel: BS1387, BS3601 and BS3602 part 1 & 2. (only type 142)
- PVC: BS3505

Materials:

- 16 mm to 63 mm: Dezincification resistant brass
- 75 to 180 mm: Ductile iron Epoxy coated
- O-rings: NBR
- Bolts: A4 high grade stainless steel

Area of applications:

- Cold water/potable water up to 40°C
- Gas (with supporting insert type 180)

Working pressure:

- Water - up to 16 bar
- Gas - up to 10 bar (with supporting insert type 180)
- Air up to 10 bar

Diverse:

- Endure diesel oil and petrol
- Contact manufacturer for any questions

All information are based on the UK marked. For more detailed information about other countries please contact our sales department!

PROGRAMUL CUPLE BRONZ / BRASS COUPLINGS PROGRAM - dimensiuni / dimensions

TYPE 100 - Cupla dreapta / Straight coupling

| D (mm) | L (mm) | NV (mm) | P (mm) |
|---------|--------|---------|--------|
| 16 x 16 | 57 | 29 | 27 |
| 20 x 20 | 59 | 33 | 28 |
| 21 x 21 | 59 | 34 | 28 |
| 21 x 20 | 59 | 34/33 | 28/28 |
| 25 x 25 | 61 | 39 | 29 |
| 27 x 25 | 61 | 41/39 | 29/29 |
| 27 x 27 | 61 | 41 | 29 |
| 32 x 32 | 69 | 48 | 33 |
| 34 x 32 | 69 | 49/48 | 32/33 |
| 34 x 34 | 69 | 49 | 32 |
| 40 x 40 | 108 | 59 | 50 |
| 42 x 40 | 89 | 60/59 | 34/50 |
| 42 x 42 | 73 | 60 | 34 |
| 49 x 50 | 99 | 70/69 | 37/53 |
| 49 x 49 | 82 | 70 | 34 |
| 50 x 50 | 114 | 69 | 53 |
| 60 x 63 | 113 | 83/76 | 40/61 |
| 60 x 60 | 88 | 83 | 40 |
| 63 x 63 | 136 | 76 | 61 |

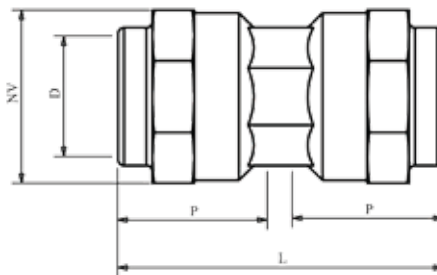
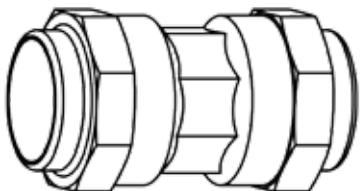

TYPE 101 - Cupla reparatie / Repair coupling

| D (mm) | L (mm) | NV (mm) | P min (mm) |
|--------|--------|---------|------------|
| 25 | 118 | 39 | 29 |
| 32 | 121 | 48 | 33 |
| 40 | 166 | 59 | 50 |
| 50 | 168 | 69 | 53 |
| 63 | 174 | 76 | 61 |

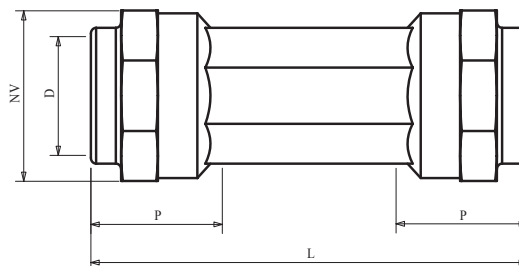
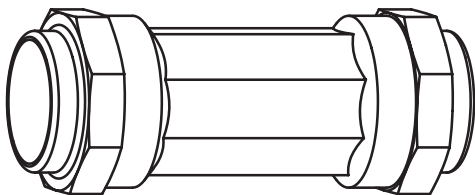

PROGRAMUL CUPLE BRONZ / BRASS COUPLINGS PROGRAM - dimensiuni / dimensions

TYPE 105/110/112 - Cupla Tata / Male coupling

| D (mm) | R (tommer) | L (mm) | NV (mm) | P (mm) |
|--------|------------|--------|---------|--------|
| 16 | 1/2 | 48 | 29 | 27 |
| 20 | 1/2 | 51 | 33 | 28 |
| 20 | 3/4 | 51 | 33 | 28 |
| 25 | 3/4 | 51 | 39 | 29 |
| 25 | 1 | 53 | 39 | 29 |
| 32 | 3/4 | 56 | 48 | 33 |
| 32 | 1 | 59 | 48 | 33 |
| 32 | 1 1/4 | 58 | 48 | 33 |
| 40 | 1 | 77 | 59 | 50 |
| 40 | 1 1/4 | 80 | 59 | 50 |
| 40 | 1 1/2 | 80 | 59 | 50 |
| 50 | 1 1/4 | 83 | 69 | 53 |
| 50 | 1 1/2 | 82 | 69 | 53 |
| 50 | 2 | 87 | 69 | 53 |
| 63 | 1 1/2 | 94 | 76 | 61 |
| 63 | 2 | 97 | 76 | 61 |

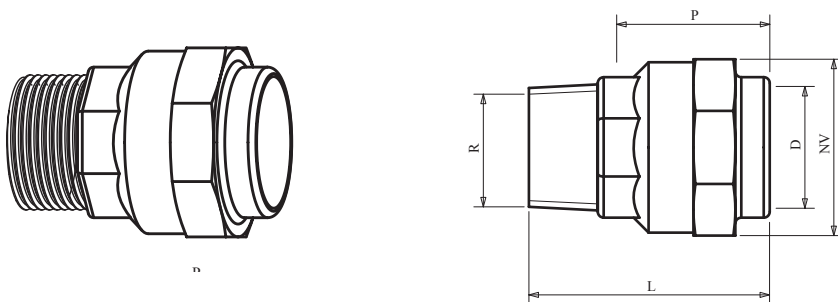

TYPE 115/116 - Cupla Mama / Female coupling

| D (mm) | R (tommer) | L (mm) | NV (mm) | P (mm) |
|--------|------------|--------|---------|--------|
| 16 | 1/2 | 42 | 29 | 27 |
| 20 | 1/2 | 42 | 33 | 28 |
| 20 | 3/4 | 44 | 33 | 28 |
| 25 | 3/4 | 45 | 39 | 29 |
| 25 | 1 | 48 | 39 | 29 |
| 32 | 3/4 | 52 | 48 | 33 |
| 32 | 1 | 52 | 48 | 33 |
| 32 | 1 1/4 | 55 | 48 | 33 |
| 40 | 1 | 72 | 59 | 50 |
| 40 | 1 1/4 | 74 | 59 | 50 |
| 40 | 1 1/2 | 74 | 59 | 50 |
| 50 | 1 1/4 | 77 | 69 | 53 |
| 50 | 1 1/2 | 77 | 69 | 53 |
| 50 | 2 | 81 | 69 | 53 |
| 63 | 2 | 92 | 76 | 61 |

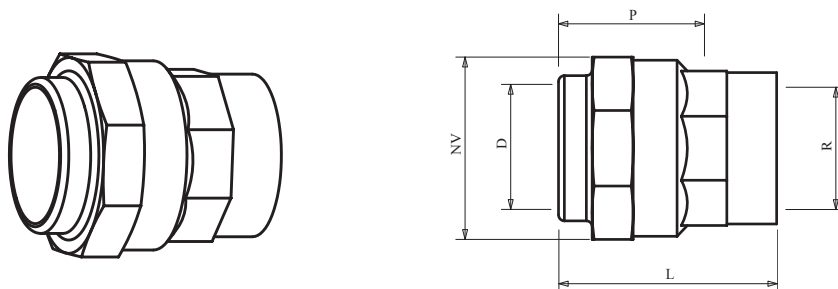

PROGRAMUL CUPLE BRONZ / BRASS COUPLINGS PROGRAM - dimensiuni / dimensions

TYPE 120 - Cot 90° / Elbow 90°

| D (mm) | L (mm) | NV (mm) | P min (mm) |
|--------|--------|---------|------------|
| 20 | 40 | 33 | 28 |
| 25 | 43 | 39 | 29 |
| 32 | 52 | 48 | 33 |
| 40 | 76 | 59 | 50 |
| 50 | 84 | 69 | 53 |
| 63 | 99 | 76 | 61 |

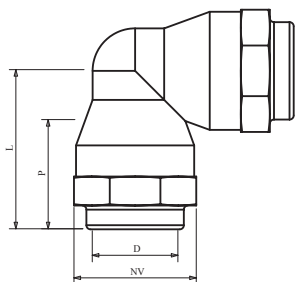
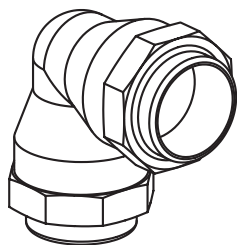

TYPE 121/124 - Cot 90° Tata / Elbow 90°, male iron

| D (mm) | R (tommer) | L (mm) | H (mm) | NV (mm) | P (mm) |
|--------|------------|--------|--------|---------|--------|
| 20 | 1/2 | 41 | 35 | 33 | 28 |
| 25 | 1/2 | 41 | 37 | 39 | 29 |
| 25 | 3/4 | 41 | 45 | 39 | 29 |
| 32 | 3/4 | 48 | 43 | 48 | 33 |
| 32 | 1 | 48 | 52 | 48 | 33 |
| 40 | 1 | 71 | 61 | 59 | 50 |
| 40 | 1 1/4 | 71 | 65 | 59 | 50 |
| 40 | 1 1/2 | 75 | 65 | 59 | 50 |
| 50 | 1 1/4 | 78 | 71 | 69 | 53 |
| 50 | 1 1/2 | 78 | 72 | 69 | 53 |
| 63 | 1 1/2 | 88 | 79 | 76 | 61 |
| 63 | 2 | 94 | 80 | 76 | 61 |

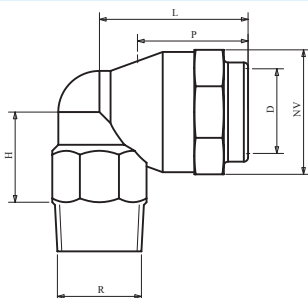
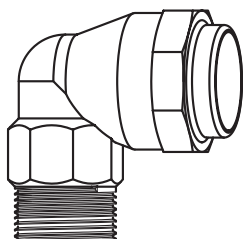

PROGRAMUL CUPLE BRONZ / BRASS COUPLINGS PROGRAM - dimensiuni / dimensions

TYPE 122 - Cot 90° Mama / Elbow 90°, female iron

| D (mm) | R (tommer) | L (mm) | H (mm) | NV (mm) | P (mm) |
|--------|------------|--------|--------|---------|--------|
| 20 | 1/2 | 40 | 22 | 33 | 28 |
| 25 | 3/4 | 43 | 26 | 39 | 29 |
| 32 | 1 | 52 | 32 | 48 | 33 |
| 40 | 1 1/4 | 76 | 37 | 59 | 50 |
| 50 | 1 1/2 | 84 | 42 | 69 | 53 |
| 63 | 2 | 98 | 52 | 76 | 61 |

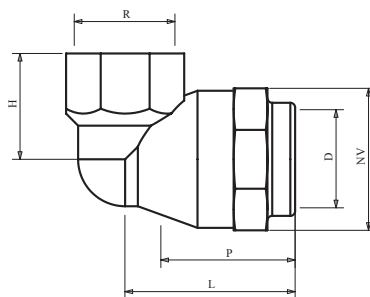
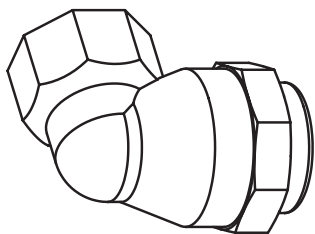

TYPE 123 - Cot 45° / Elbow 45°

| D (mm) | L (mm) | NV (mm) | P min (mm) |
|--------|--------|---------|------------|
| 25 | 36 | 39 | 29 |
| 32 | 42 | 48 | 33 |
| 40 | 63 | 59 | 50 |
| 50 | 68 | 69 | 53 |
| 63 | 82 | 76 | 61 |

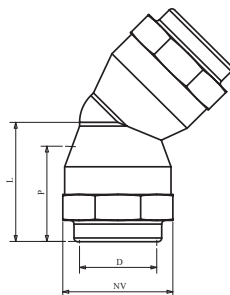
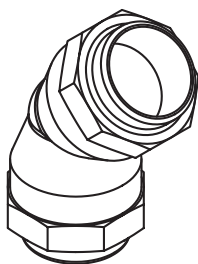

PROGRAMUL CUPLE BRONZ / BRASS COUPLINGS PROGRAM - dimensiuni / dimensions

TYPE 125/130 Teu / Tee

| D (mm) | E (mm) | L (mm) | H (mm) | NV (mm) | P (mm) |
|--------|--------|--------|--------|---------|--------|
| 16 | 16 | 75 | 37 | 29 | 27 |
| 20 | 16 | 80 | 40 | 33/29 | 28/27 |
| 20 | 20 | 81 | 40 | 33 | 28 |
| 25 | 20 | 87 | 43 | 39/33 | 29/28 |
| 25 | 25 | 86 | 43 | 39 | 29 |
| 32 | 25 | 105 | 51 | 48/39 | 33/29 |
| 32 | 32 | 105 | 52 | 48 | |
| 40 | 32 | 145 | 55 | 59/48 | 50/33 |
| 40 | 40 | 152 | 76 | 59 | 50 |
| 50 | 32 | 157 | 62 | 69/48 | 53/33 |
| 50 | 40 | 157 | 81 | 69/59 | 53/50 |
| 50 | 50 | 168 | 84 | 69 | 53 |
| 63 | 32 | 165 | 69 | 76/48 | 61/33 |
| 63 | 40 | 172 | 87 | 76/59 | 61/50 |
| 63 | 63 | 193 | 100 | 76 | 61 |

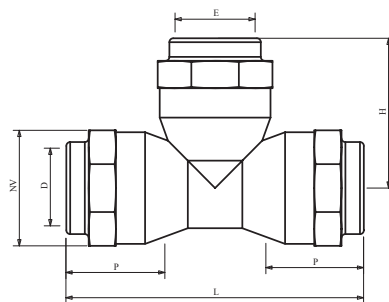
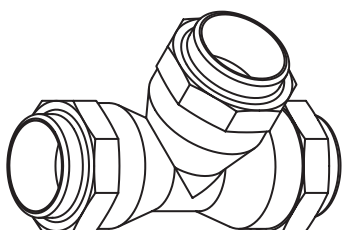

TYPE 129 - Cot 90° pivotant / Swivel Elbow 90°

| D (mm) | R (tommer/inch) | L (mm) | H (mm) | NV (mm) | P(mm) |
|--------|-----------------|--------|--------|---------|-------|
| 32 | 1 1/4 | 48 | 80 | 48 | 33 |
| 32 | 1 1/2 | 48 | 80 | 48 | 33 |
| 40 | 1 1/4 | 71 | 93 | 59 | 50 |
| 40 | 1 1/2 | 71 | 90 | 59 | 50 |
| 50 | 1 1/2 | 77 | 96 | 69 | 53 |
| 63 | 1 1/2 | 88 | 103 | 76 | 61 |

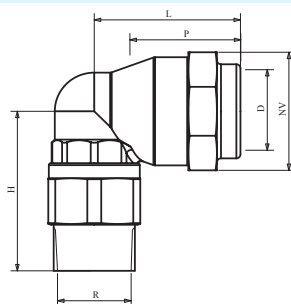
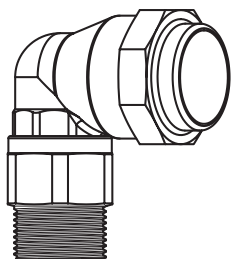

PROGRAMUL CUPLE BRONZ / BRASS COUPLINGS PROGRAM - dimensiuni / dimensions

TYPE 131 - Teu Tata / Tee, male branch

| D (mm) | R (tommer/inch) | L (mm) | H (mm) | NV (mm) | P (mm) |
|--------|-----------------|--------|--------|---------|--------|
| 20 | 1/2 | 74 | 35 | 33 | 28 |
| 25 | 3/4 | 79 | 39 | 39 | 29 |
| 32 | 1 | 96 | 47 | 48 | 33 |
| 40 | 1 1/4 | 142 | 54 | 59 | 50 |
| 50 | 1 1/2 | 153 | 59 | 69 | 53 |
| 63 | 2 | 187 | 71 | 76 | 61 |

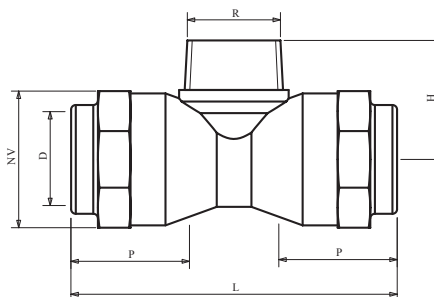
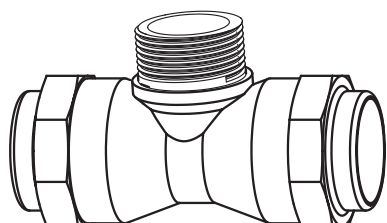

TYPE 132 - Teu Mama / Tee, female branch

| D (mm) | R (tommer/inch) | L (mm) | H (mm) | NV (mm) | P (mm) |
|--------|-----------------|--------|--------|---------|--------|
| 20 | 1/2 | 81 | 27 | 33 | 28 |
| 25 | 3/4 | 86 | 31 | 39 | 29 |
| 32 | 1 | 105 | 36 | 48 | 33 |
| 40 | 1 1/4 | 152 | 42 | 59 | 50 |
| 50 | 1 1/2 | 157 | 57 | 69 | 53 |
| 63 | 2 | 187 | 60 | 76 | 61 |

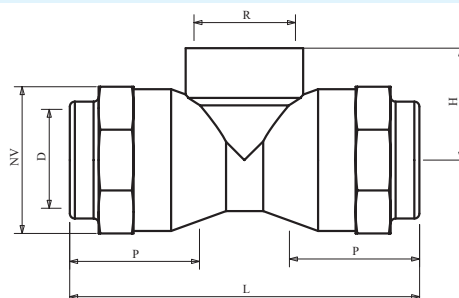
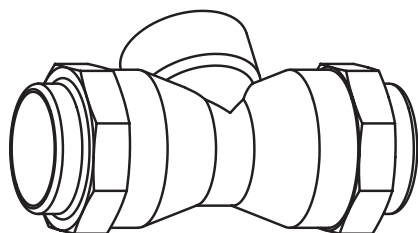

PROGRAMUL CUPLE BRONZ / BRASS COUPLINGS PROGRAM - dimensiuni / dimensions

TYPE 135/140 Reductie / Reducer

| D (mm) | E (mm) | NV (mm) |
|--------|--------|---------|
| 25 | 16 | 29 |
| 25 | 20 | 33 |
| 32 | 20 | 33 |
| 32 | 25 | 39 |
| 40 | 25 | 39 |
| 40 | 32 | 48 |
| 40 | 38 | 59 |
| 50 | 32 | 48 |
| 50 | 40 | 59 |
| 63 | 40 | 59 |
| 63 | 50 | 69 |
| 63 | 57 | 80 |

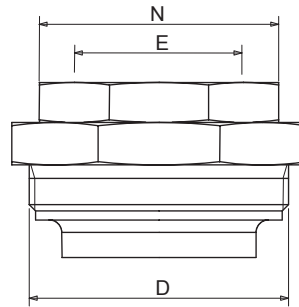
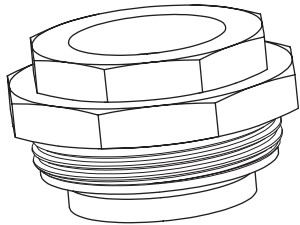

TYPE 142 Adaptor teava Otel / Adaptor for steel pipes

| D (mm) | R (tommer/inches) |
|--------|-------------------|
| 25 | 3/4 |
| 32 | 1 |
| 40 | 1 1/4 |
| 50 | 1 1/2 |
| 63 | 2 |

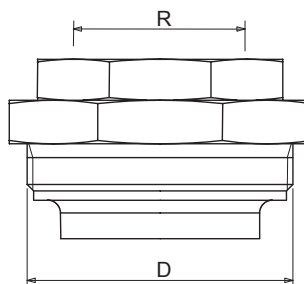
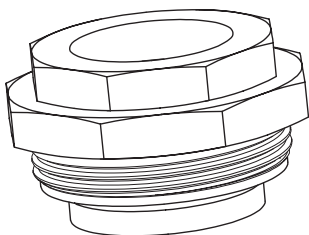

PROGRAMUL CUPLE BRONZ / BRASS COUPLINGS PROGRAM - dimensiuni / dimensions

TYPE 144 Niplu dublu / *Double connecting nipple*

D (mm)

32
40
50
63

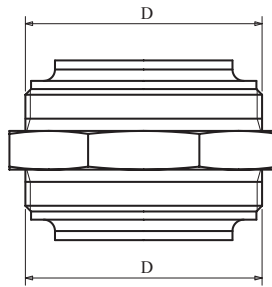
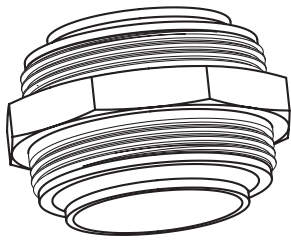

TYPE 145 Dop / *Blanking plug*

D (mm)

16
20
25
32
40
50
63

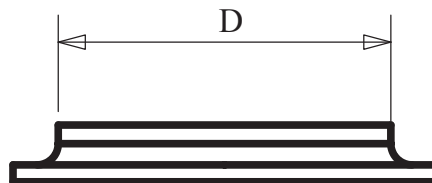
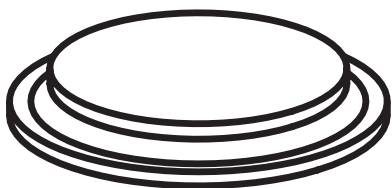

PROGRAMUL CUPLE BRONZ / BRASS COUPLINGS PROGRAM - dimensiuni / dimensions

TYPE 146/147 Niplu Tata / Connecting male nipple

| D (mm) | R (tommer/inches) | H (mm) | NV (mm) |
|--------|-------------------|--------|---------|
| 16 | 1/2 | 23 | 29 |
| 20 | 1/2 | 23 | 33 |
| 20 | 3/4 | 24 | 33 |
| 25 | 3/4 | 24 | 39 |
| 25 | 1 | 28 | 39 |
| 32 | 1 | 29 | 48 |
| 32 | 1 1/4 | 31 | 48 |
| 40 | 1 1/4 | 31 | 60 |
| 40 | 1 1/2 | 32 | 60 |
| 50 | 1 1/2 | 32 | 69 |
| 50 | 2 | 35 | 69 |
| 63 | 2 | 34 | 83 |

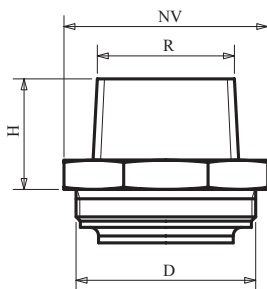
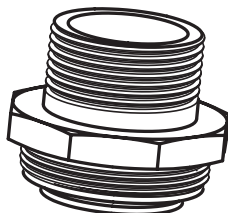

TYPE 148/149 Niplu Mama / Connecting female nipple

| D (mm) | R (tommer/inches) | H (mm) | NV (mm) |
|--------|-------------------|--------|---------|
| 16 | 3/8 | 6 | 29 |
| 20 | 3/8 | 5 | 33 |
| 20 | 1/2 | 7 | 33 |
| 25 | 1/2 | 7 | 39 |
| 25 | 3/4 | 7 | 39 |
| 32 | 3/4 | 7 | 48 |
| 32 | 1 | 7 | 48 |
| 40 | 1 | 7 | 60 |
| 40 | 1 1/4 | 7 | 60 |
| 50 | 1 1/4 | 7 | 69 |
| 50 | 1 1/2 | 7 | 69 |
| 63 | 2 | 7 | 83 |

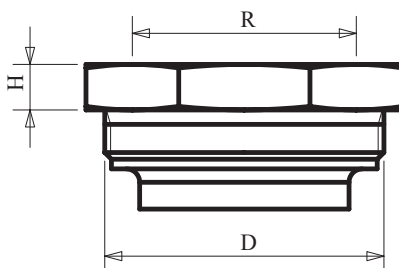
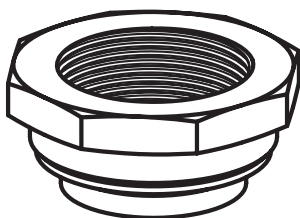

PROGRAMUL CUPLE BRONZ / BRASS COUPLINGS PROGRAM - dimensiuni / dimensions

TYPE 150 - Cot 90° fixare perete / Elbow 90°, wall fixing

| D (mm) | R (tommer/inch) | L (mm) | H (mm) | S (mm) | NV (mm) |
|--------|-----------------|--------|--------|--------|---------|
| 16 | 1/2 | 44 | 23 | 45 | 29 |
| 20 | 1/2 | 44 | 23 | 45 | 33 |
| 25 | 1/2 | 44 | 23 | 45 | 39 |
| 25 | 3/4 | 44 | 23 | 45 | 39 |

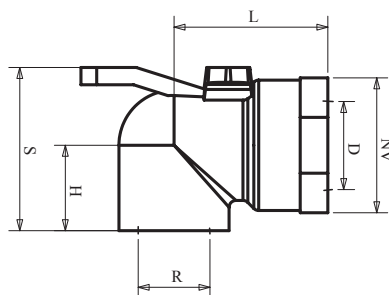
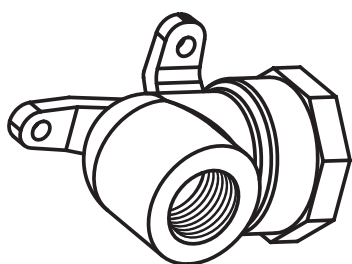

TYPE 200 - Vana trecere / Gate valve

| D (mm) | L (mm) | NV (mm) | P min (mm) |
|--------|--------|---------|------------|
| 25 | 119 | 39 | 29 |
| 32 | 136 | 48 | 33 |
| 40 | 179 | 59 | 50 |
| 50 | 201 | 69 | 53 |
| 63 | 208 | 76 | 61 |

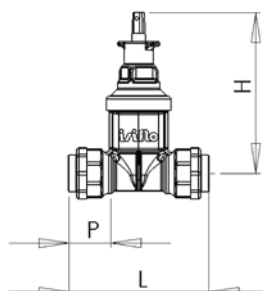
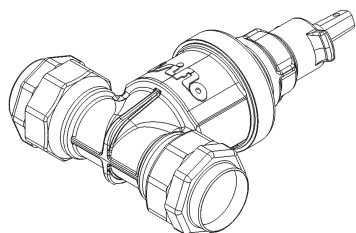

PROGRAMUL CUPLE BRONZ - Tabel de ghidare pentru alegerea corecta a tevelor si cuplelor.

| ISIFLO- dimensiuni | PE-PVC-PP | PE Imperial | Teava (Cu Dimensiune Inch) | Teava (Cu Dimensiune mm) | Teava capilara | Teava Otel (Cu Dimensiune Inch) | Teava Otel (Cu Dimensiune mm) |  |
|-----------------------|-----------|-------------|-------------------------------|-----------------------------|----------------|------------------------------------|----------------------------------|---|
| 16 | 16 | | 5/8"F | 15,8 | 16 | | | Isiflo Standard |
| 20 | 20 | | | | | | | Isiflo Standard |
| 21 | | 21 | | | | | | Isiflo standard Imperial |
| 22 x 25 | | | 1"F | 25,4 | 22 | | | Isiflo Tip 100 Isiflo reparatie Cu/ teava capilara |
| 22 x 3/4" | | | | | 7/8" | 22,2 | | Isiflo Tip 110 |
| 25 | 25 | | 1"F | 25,4 | | | | Fitinguri Standard |
| 27 | | 27 | 3/4" | 26,4 | | | | Isiflo Standard Imperial |
| 1"F x 28 | | | 1"F | 25,4 | 28 | | | Isiflo Tip 100 Cupla reparatii - Cu/Capilar |
| 32 | 32 | | 1.1/4"F | 31,7 | | | | Isiflo Standard |
| 34 | | 34 | 1" | 33,2 | | | | Isiflo Standard Imperial |
| 1.1/4"F x 35 | | | 1.1/4"F | 31,7 | 35 | | | Isiflo Tip 100 Cupla reparatii - Cu/Capilar |
| 40 x 38 | | | 1.1/2"F | 38,1 | | | | Isiflo Tip 140 40x38 mm 1.1/2" Cu |
| 40 | 40 | | | | | | | Isiflo Standard |
| 1.1/2"F x 42 | | | 1.1/2"F | 38,1 | 42 | | | Isiflo Type 100 Cupla reparatie - Cu/Capilar |
| 1.5/8"F x 42 | | | 1.5/8"F | 41,3 | 42 | | | Isiflo Type 100 Cupla reparatie - Cu/Capilar |
| 42 | | 42 | 1.1/4" | 41,9 | 42 | | | Isiflo Standard Imperial |
| 1.3/4"F x 42 | | | 1.3/4"F | 44,5 | 42 | | | Isiflo Type 100 Cupla reparatie - Cu/Capilar |
| 49 | | 49 | | | | | | Isiflo Standard Imperial |
| 50 | 50 | | 2"F | 50,8 | | | | Isiflo Standard |
| 2"F x 54 | | | 2"F | 50,8 | 54 | | | Isiflo Type 100 Cupla reparatie - Cu/Capilar |
| 60 | | 60 | 2" | 59,6 | | | | Isiflo Standard Imperial |
| 63 x 57 | | | 2.1/4" | 57,14 | | | | Isiflo Adaptor Tip 140 |
| 63 | 63 | | 2,1/2" | 63,5 | | | | Isiflo Fiting Standard |
| 3/4"R x 25 | | | 3/4" | 26,9 | | 3/4" | 26,9 | Adaptor Otel tip 142 |
| 1"R x 32 | | | 1" | 33,7 | | 1" | 33,7 | Adaptor Otel tip 142 |
| 1.1/4R x 40 | | | 1.1/4" | 42,4 | | 1.1/4" | 42,4 | Adaptor Otel tip 142 |
| 1.1/2"R x 50 | | | 1.1/2" | 48,3 | | 1.1/2" | 48,3 | Adaptor Otel tip 142 |
| 2"R x 63 | | | 2" | 60,3 | | 2" | 60,3 | Adaptor Otel tip 142 |

ISIFLO BRASS COUPLINGS - Productfinder - dimensions

| ISIFLO- dimension | PE-PVC-PP | PE Imperial | CU pipes (inch dimension) | CU pipes (mm dimension) | Capillary pipes | Galvanised steel pipes BSP | Galvanised steel pipes in mm |  |
|----------------------|-----------|-------------|------------------------------|----------------------------|-----------------|-------------------------------|---------------------------------|---|
| 16 | 16 | | 5/8"F | 15,8 | 16 | | | Isiflo standard fittings |
| 20 | 20 | | | | | | | Isiflo standard fittings |
| 21 | | 21 | | | | | | Isiflo imperial standard |
| 22 x 25 | | | 1"F | 25,4 | 22 | | | Isiflo Type 100 repair coupling - Cu/Capillary |
| 22 x 3/4" | | | | | 7/8" | 22,2 | | Isiflo Type 110 |
| 25 | 25 | | 1"F | 25,4 | | | | Isiflo standard fittings |
| 27 | | 27 | 3/4" | 26,4 | | | | Isiflo imperial standard |
| 1"F x 28 | | | 1"F | 25,4 | 28 | | | Isiflo Type 100 repair coupling - Cu/Capillary |
| 32 | 32 | | 1.1/4"F | 31,7 | | | | Isiflo standard fittings |
| 34 | | 34 | 1" | 33,2 | | | | Isiflo imperial standard |
| 1.1/4"F x 35 | | | 1.1/4"F | 31,7 | 35 | | | Isiflo Type 100 repair coupling - Cu/Capillary |
| 40 x 38 | | | 1.1/2"F | 38,1 | | | | Isiflo Type 140 40x38 mm 1.1/2" Cu |
| 40 | 40 | | | | | | | Isiflo standard fittings |
| 1.1/2"F x 42 | | | 1.1/2"F | 38,1 | 42 | | | Isiflo Type 100 repair coupling Cu/Capillary |
| 1.5/8"F x 42 | | | 1.5/8"F | 41,3 | 42 | | | Isiflo Type 100 repair coupling Cu/Capillary |
| 42 | | 42 | 1.1/4" | 41,9 | 42 | | | Isiflo imperial standard |
| 1.3/4"F x 42 | | | 1.3/4"F | 44,5 | 42 | | | Isiflo Type 100 repair coupling Cu/Capillary |
| 49 | | 49 | | | | | | Isiflo imperial standard |
| 50 | 50 | | 2"F | 50,8 | | | | Isiflo standard fittings |
| 2"F x 54 | | | 2"F | 50,8 | 54 | | | Isiflo Type 100 repair couplings Cu/Capillary |
| 60 | | 60 | 2" | 59,6 | | | | Isiflo imperial standard |
| 63 x 57 | | | 2.1/4" | 57,14 | | | | Isiflo Type 140 adaptor |
| 63 | 63 | | 2.1/2" | 63,5 | | | | Isiflo standard fittings |
| 3/4"R x 25 | | | 3/4" | 26,9 | | 3/4" | 26,9 | Isiflo Type 142 steel adaptor |
| 1"R x 32 | | | 1" | 33,7 | | 1" | 33,7 | Isiflo Type 142 steel adaptor |
| 1.1/4R x 40 | | | 1.1/4" | 42,4 | | 1.1/4" | 42,4 | Isiflo Type 142 steel adaptor |
| 1.1/2"R x 50 | | | 1.1/2" | 48,3 | | 1.1/2" | 48,3 | Isiflo Type 142 steel adaptor |
| 2"R x 63 | | | 2" | 60,3 | | 2" | 60,3 | Isiflo Type 142 steel adaptor |

CATALOG CUPLE BRONZ / BRASS COUPLINGS - material/material

Ce este dezincarea - What is dezincification?

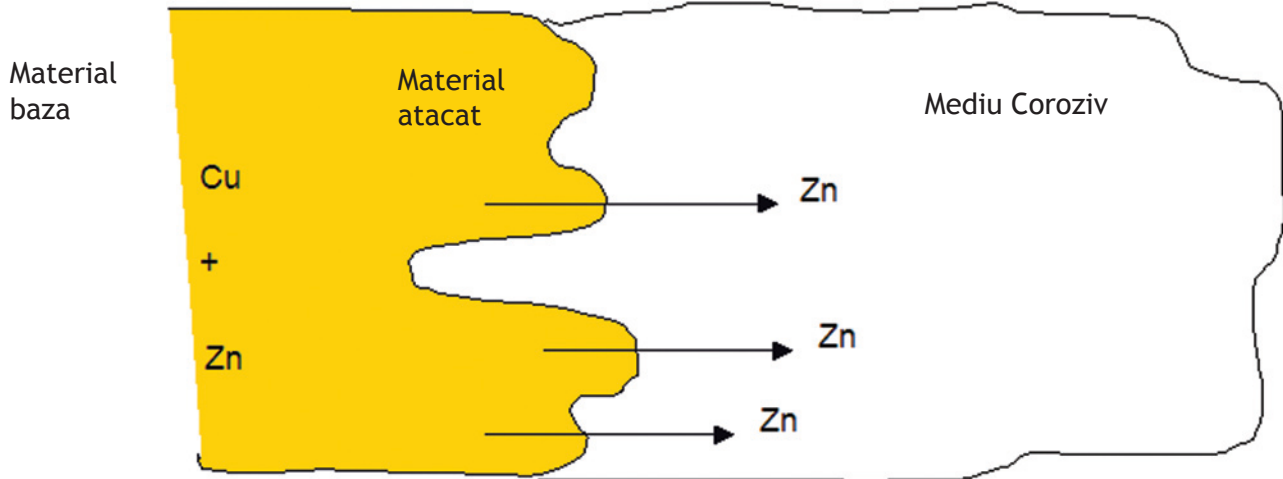

Dezincarea este o coroziune selectiva. In cazul dezincarii bronzului, zincul se dizolva si rezulta cuprul poros si oxid de cupru. Aliajul poate parea nemodificat cu exceptia matuirii suprafetei, dar rezistenta sa este mult redusa

Dezincification is a type of selective corrosion. In case of dezincification of brass, the zinc dissolves and leaves a porous copper and copper oxide behind. The alloy may appear undamaged except for a tarnished surface, but its strength and ductility are seriously reduced.

Raufoss - Bronz-450 / Brass

Comparatie cu alte aliaje
Compared with other alloys



Aliaj Raufoss-450
Faza neagra=beta granule
Marimea granulei=20 µm
Factor marire=X250

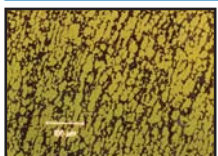

Aliaj Ms58
Faza intunecata=granule beta
Marimea granulei=20 µm
Factor de marire=X250

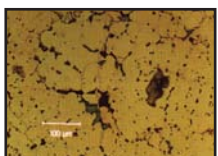

Distributia aliajului
Plumb= particulele albastrii
Marimea granulei=300 µm

Raufoss - 450 Avsinkningsbestandig Messing / DZR

Test in conditii de apa de mare, timp de 10 ani -
Test conditions 10 years in seawater



Ms58



RAUFOSS-450

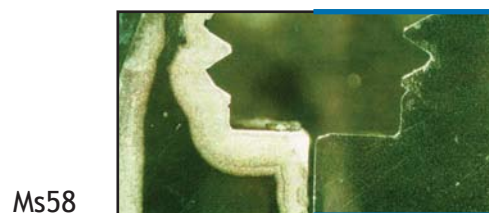

Ms58

Raufoss 450

Dezincare

Fara dezincare

CATALOG CUPLE BRONZ / BRASS COUPLINGS - material/material

Raufoss-450 - Bronz rezistent la dezincare (DZR) - Dezincification resistant brass (DZR)

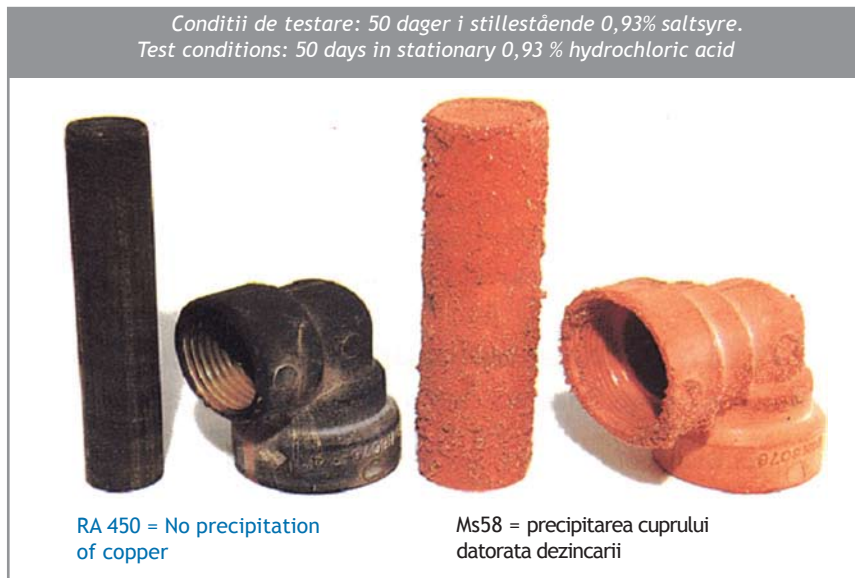

Aliajul de cupru-zinc cu mai puțin de 37% zinc este denumit bronz-alpha la temperatura camerei. Cu mai mult de 37% zinc într-un aliaj de cupru-zinc, obținem o structură adițională numită beta. Atomii se vor organiza diferit ca în cazul fazei alpha și unele granule din metal vor fi din faza beta. Numărul de particule beta creșcând cu cantitatea de zinc. Nu există particule alpha în bronzul cu mai mult de 47% zinc.

Copper-zinc alloys with less than 37% zinc are called alpha-brasses at room temperature. With more than 37% zinc in a copper-zinc alloy, you get an additional structure called beta. The atoms will organise differently than in the alpha-phase, and some grains in the metal will be of beta-phase. The amount of beta-phase increases with the amount of zinc. There is no alpha-phase in a brass with more than 47% zinc.

In the case of the Raufoss-450 alloy, the zinc-content is 36%.

Addition of a small amount of arsenic to alpha-brasses inhibits dezincification, but alpha-brasses are not easily hot-formed. On the other hand, beta-brasses are not protected from dezincification by addition of arsenic. Caused by transformation of the alloy into a mixture of alpha and beta-brass when it is heated, Raufoss-450 is more easily hot-formed. When it is cooled, it transforms back, and the Raufoss-450 alloy still does not contain more than 3% beta-phase.

Instructiuni Montaj

Instalare:

- Taiati teava si debavurati.
- Slabiti piulita fara sa o demontati.
- Impingeti teava pana se opreste.
- Stringeti piulita.

Important:

O buna etansare se obtine cand teava este impinsa peste garnitura, pana in pragul care opreste teava, iar piulita este stransa pana la contactul cu gulerul corpului.

Cand utilizam cuplele Isiflo la tevi de cupru sau otel, trebuie ca intre capatul tevi si pragul de oprire sa ramana o distanta de 3mm.

Assembly instructions

Installation:

- Cut the pipe, deburr.
- Loosen the nut, do not dismantle.
- Push the pipe to the stop.
- Tighten the nut against the body.

Important:

A good seal is only obtained when the pipe is pushed past the O-ring, up to the pipe stop and the nut is tightened against the body.

When using Isiflo couplings on copper or steel pipes, shall the pipe always be installed with a clearance of approx. 3 mm from the internal stop.

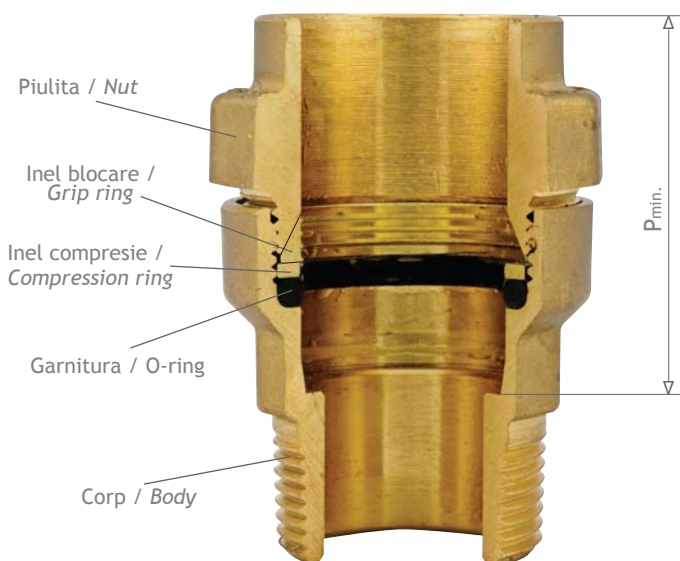
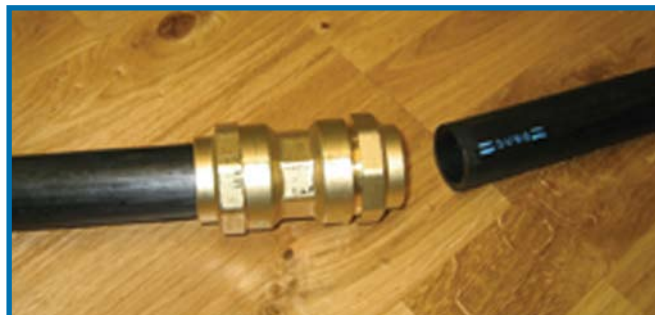

Distanta de introducere/Insert distance: P_{min} Isiflo messing

| Dim. | P mm |
|-------|-------|
| 20 mm | 28 mm |
| 25 mm | 29 mm |
| 32 mm | 33 mm |
| 40 mm | 51 mm |
| 50 mm | 54 mm |
| 63 mm | 56 mm |

Pentru fonta ductila/ For Isiflo Ductile Iron:

Distanta de introducere/Insert distance (min./max)

| Dim | Min | Max |
|--------|--------|--------|
| 75 mm | 61 mm | 70 mm |
| 90 mm | 61 mm | 71 mm |
| 110 mm | 77 mm | 87 mm |
| 160 mm | 106 mm | 116 mm |

Folositi «sitemul LEGO» / Use of the «building block system»

reduceti sau refaceti filetele exterioare sau interioare ale tevi / reduces or rebuilds to inside and outside pipe threads

Reconstruiti astfel / rebuilding like this;

Scoateti piulita, inelul de blocare, inelul de compresie, lasati garnitura.
 Remove nut, grip ring, compression ring, leave the O-ring.

Isurubati in noua piesa
 Skrew in new part.



=



Exemple/Examples:

Necesar/required: Cot/Elbow 40 mm x 1 1/2"

Utilizare/use: Tip 120, 40 x 40 mm

+ Tip 146. 40 mm x 1 1/2"

Rezultat/Result: Cot/Elbow 40 mm x 1 1/2"

Tip 120, 40 x 40 mm

Scoateti piulita, inelul de blocare, inelul de compresie
 Remove nut, grip ring, compression ring

Insurubati in Tip 146. 40 mm x 1 1/2"
 Skrew in type 146, 40 mm x 1 1/2"



=



Folositi «sistemul Lego» / Use of the «building block system»

Necesar/required: Cupla reparatie / Repair coupling 50 mm x 1 1/4"
 Folositi/use: Tip 101, 50 x 50 mm
 + Tip 149. 50 mm x 1 1/4"
 Rezultat/result: Cupla reparatie / Repair coupling 50 mm x 1 1/4"

Tip 101, 50 x 50 mm



Scoateti piulita, inelul de blocare,
 inelul de compresie
 Remove nut, grip ring, compression ring



=

Insurubati in Tip 149. 50 mm x 1 1/4"
 Skrew in type 149, 50 mm x 1 1/4"



Necesar/required: Teu /Tee 25 mm x 1/2" x 25 mm
 Folositi/use: Tip 125, 25 x 25 x 25 mm
 + Tip 149, 25 x 1/2"
 Rezultat/result: Teu /Tee 25 mm x 1/2" x 25 mm

Tip 125, 25 x 25 x 25 mm

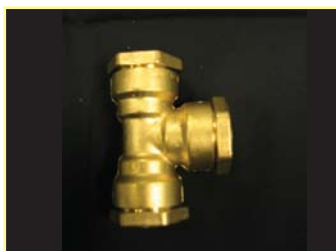

Desfaceti piulita, inelul de blocare,
 inelul de compresie
 Remove nut, grip ring, compression ring



=

Insurubati in Tip 149. 25 mm x 1/2" x 25 mm
 Skrew in type 149, 25 mm x 1/2" x 25 mm



Folosirea tuburilor flexibile / Use of flexible hose

Cuple de reparatie pentru tevi de cupru / Rep.coupling for CU-copper

Aceste cuple dau posibilitatea fixarii cuplelor pe tevi cu diametrul 1", 1 1/4", 1 1/2", 1 5/8", 1 3/4" og 2" etter NS 824 majorat la: 28 mm, 35 mm, 42 mm eller 54 mm etter NS 1758.

These coupling give the opportunity for fixing couplings of CU-copper 1", 1 1/4", 1 1/2", 1 5/8", 1 3/4" og 2" (NS 824) with maximizing a pipe 28 mm, 35 mm, 42 mm eller 54 mm (NS 1758).

Type 100 Cuple de reparatie pentru cupru / Rep.coupling for CU-Copper.

| | |
|--------------|--------------|
| 20mm 3/4" | Cu (22,0 mm) |
| 28 mm 1" | Cu (25,4 mm) |
| 35 mm 1 1/4" | Cu (31,8 mm) |
| 42 mm 1 1/2" | Cu (38,1 mm) |
| 42 mm 1 5/8" | Cu (41,3 mm) |
| 42 mm 1 3/4" | Cu (44,5 mm) |
| 54 mm 2" | Cu (50,8 mm) |

Utilizare: Cupla este facuta ca o cupla de reparatie si este posibil sa o putem deplasa peste teava de diametru mai mic
Use: Coupling is made as repair coupling and is possible to move over the smallest pipe diameter.

Exemplu 1: teava de cupru de diametru 1 1/4" - cupla de reparatie-tip 100 - 35 mm x 114", -teva de cupru de diametru 35mm de aceeasi lungime ca distanta dintre capetele de teava si care trebuie conectate si care trebuie sa fie in aceeasi directie cu teava de 1 1/4". Cuplele de reparatie se deplaseaza pe deasupra tevii de cupru de 35mm diametru pana la fixare.

Example 1: With maximizing or repairing of f.e. 1" Cu-pipe - put rep.coupling type 100 - 35 mm x 1 1/4" Cu-pipe over 1 1/4" Cu-pipe. 35 mm Cu-pipe with same length like the distance between pipe ends has to be in same direction with 1 1/4" Cu-pipe. Rep. couplings moves over 35 mm Cu-pipe until fixed.



1 1/4" Cu

35 mm Cu

1 1/4" Cu



1 1/4" Cu

35 mm Cu

1 1/4" Cu

Type 100, 35 mm x 1 1/4" Cu

Type 100, 35 mm x 1 1/4" Cu

Teava PE standard Imperial / Imperial standard PE-pipes

Tevile de plastic cu diametre mai timpuri in inch sunt inca in utilizare.

Isiflo are 3 tipuri de cuple pentru repararea acestora

Plastic pipes in earlier inch-dimensions (imperial standard) are still in use.

Isiflo has 3 types of couplings for repairing this kind of pipes;

Type 100, Cupla directa / Straight coupling

21 x 20 mm

27 x 25 mm

34 x 32 mm

42 x 40 mm

49 x 50 mm

60 x 63 mm

Type 110, Cupla Mama-Tata / Male and female coupling

21 mm x 1/2"

27 mm x 3/4"

32 mm x 1"

42 mm x 1 1/4"

49 mm x 1 1/2"

60 mm x 2"

Exemple pentru conectarea tevilor cu aceste cuple: (recomandam varianta 1)

Examples for connecting pipes with these couplings: (we recommend alternative 1)

Alt. 1:



Type 100, 34 x 32 mm

Type 100, 34 x 32 mm

Alt. 2:

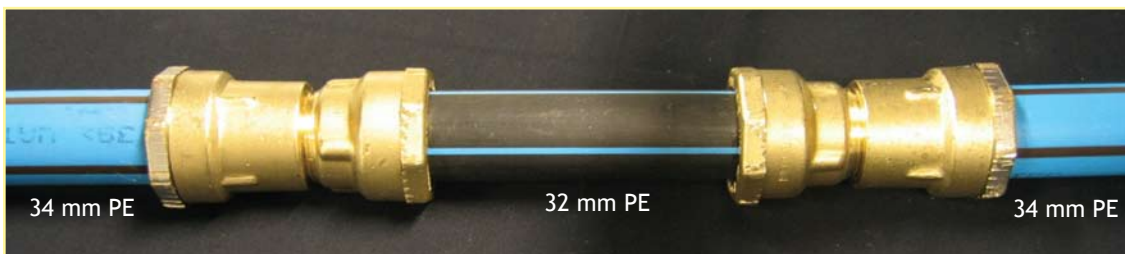

Type 110,
34 x 1"

Type 116,
32 mm x 1"

Type 116,
32 mm x 1"

Type 110,
34 x 1"

Adaptor pentru teava OI/Cu - *Adaptor for steelpipes / copper pipes*

Adaptorul pentru tevide de otel tip 142 este facut pentru a realiza operatia de reparare a tevi fara a fi nevoie de a face filete pe teava.

Adaptorul nostru pentru otel, are inelul de blocare din otel inoxidabil, care efectueaza cea mai eficienta blocare a tevi de otel si o garnitura speciala, care etansaza chiar si pe tevi corodate si cu suprafata neregulata.

Adaptorul este construit cu dimensiuni de la 25mm X3/4" pana la 63mm X2"

The adapter for steel pipes type 142 is developed to meet the need of fast and simple repair of steel pipes without the need of making threads direct on the steel pipe.

Our steel adapter is made with a clamp ring in stainless steel to give the best possible grip, and a special made O-ring shall secure a reliable sealing also on corroded pipes and pipes with uneven surface finish.

The adapter are made in dimensions from 25 mm x 3/4" to 63 mm x 2".

Exemplu de reparatie a tevi de OI. / *Example repairing of steelpipes:*



Adaptor pentru teava de cupru / *Adaptor for copper pipes*

Cuplele standard Isiflo sunt aprobate pentrtevi de cupru(NS 824) cu dimensiunile de 5/8"(16mm), 1"(25mm), 11/4"(32mm).

Pentru 11/2" folositi adaptor tip 140 cu dimensiunea de 40mmX11/2"(38.1mm)

Standard Isiflo couplings are approved for copper pipes (NS 824) in dimensions 5/8" (16 mm), 1" (25 mm) og 1 1/4" (32 mm). For 1 1/2" copper pipes use adaptor type 140 in dimension 40 mm x 1 1/2" (38,1 mm).

Exemplu de reparare a tevi de Cu. / *Example for repairing of copper pipes:*



Raufoss Water & Gas AS

Boks 143, 2831 Raufoss, Norway.

Ordretelefon: 61 15 22 38 / 61 15 22 24

Faks: 61 15 20 62

E-mail: info@isiflo.com

www.isiflo.com

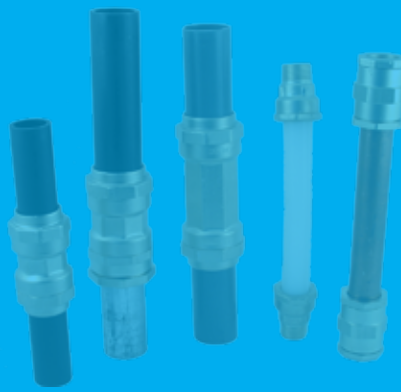

isiflo[®]



Broen Sei

Str. Fabricii 47, Corp X, Et.4

Sector 6

060821 Bucuresti, Romania

Telefon:

+40 21 316 96 18

+40 21 316 96 19

+40 21 316 96 20

Fax:

+40 21 316 96 21

E-mail:

office@broen.ro

Website:

www.broen.ro